

ESCADARIA

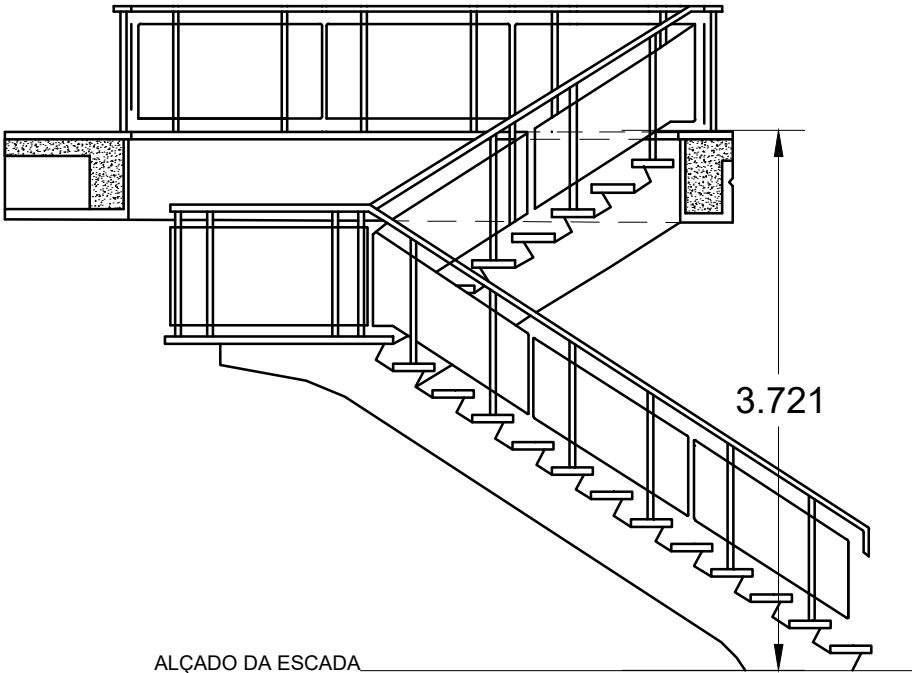

ALÇADO DA ESCADA

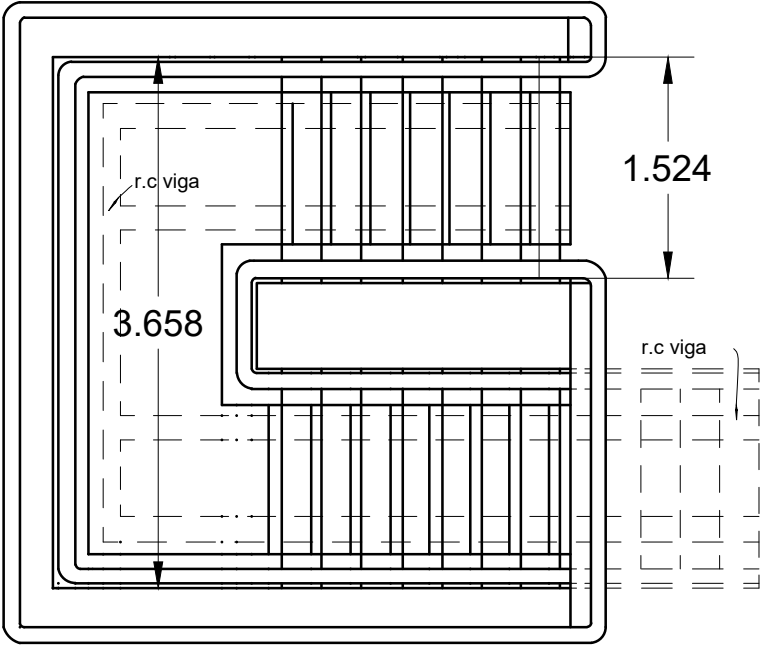

ex 0.114m x 0.015m  
corrimão de mogno polido

0.076m de diâmetro  
x 0.006m placa soldada  
a padrão e stove  
pintado a branco

parafuso polido e  
envernizado com  
cabeça de bronze

0.034m de diâmetro,  
(stove) pintado  
a branco

0.095m de  
vidro  
transparente

exterior em bronze  
e envernizado  
0.016m de diâmetro,  
haste soldada

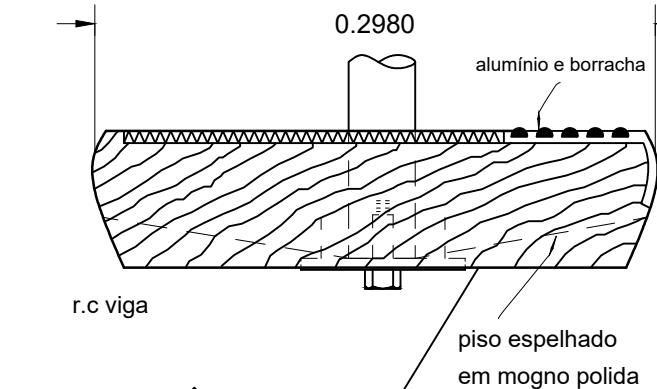

CORTE ESCADA escala 1/4

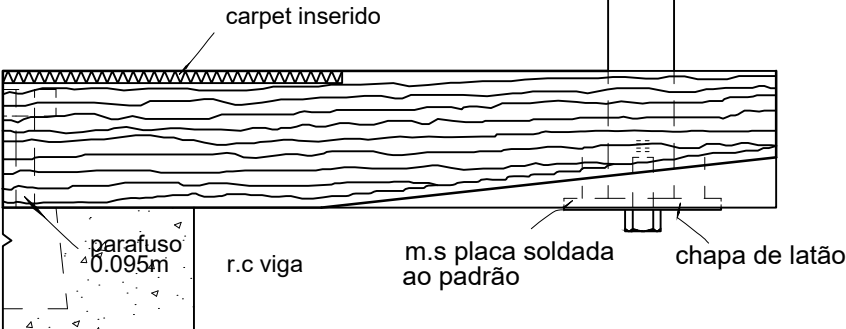

CORTE TRANSVERSAL ATRAVÉS DO PISO BALAUSTRÉ